

# ASSEMBLY INSTRUCTIONS



MODEL 90154820T **Crescent 4 Person Dome 8' x 7'**

## SAFETY WARNING - DOs AND DO NOTs

EVERYONE WHO USES THIS TENT SHOULD READ THIS MANUAL AND BECOME FAMILIAR WITH ALL SAFETY WARNINGS AND PRECAUTIONS FOR SAFE USE, ASSEMBLY, CARE, MAINTENANCE, AND STORAGE. KEEP THIS MANUAL SO YOU CAN REFER TO IT LATER.

### **⚠ DANGER** CARBON MONOXIDE GAS WILL KILL YOU

Stoves, heaters, grills, lantern, candles, and other fuel-burning devices that burn propane, natural gas, charcoal, kerosene, coal, or other fuels produce a toxic gas called carbon monoxide. Because carbon monoxide gas is invisible, odorless, and colorless, a dangerous level of carbon monoxide gas can accumulate in a tent which cannot be detected by sight, smell, or taste. For these reasons:

- DO NOT use matches, lighters, stoves, heaters, grills, lanterns, candles, cooking equipment, or other fuel-burning devices inside or near a tent.
- DO NOT build fires inside or near a tent.
- DO NOT leave campfires unattended.

Your failure to follow this warning will cause death, serious injury, or permanent disability to you or others.

### **⚠ DANGER** PROTECT YOUR CHILDREN

- DO NOT leave children unattended inside a tent or in camp.
- DO NOT allow children to assemble a tent.
- DO NOT allow children to enter or exit a tent except through the door.
- DO NOT allow children to remain in a closed-up tent on hot days.

Your failure to follow this warning will cause death, serious injury, or permanent disability to your children.

### **⚠ WARNING** FLAMMABILITY WARNING KEEP ALL FLAME AND HEAT SOURCES AWAY FROM THIS TENT FABRIC

This tent is made with flame resistant fabric which meets CPAI-84 specification. IT IS NOT FIREPROOF. The fabric will burn if left in continuous contact with any flame source. The application of any foreign substance to the tent fabric may render the flame-resistant properties ineffective. Your failure to follow this warning could cause death, serious injury, or permanent disability to you or others.

### **CAMPING DO'S AND DON'TS**

#### **DO NOT...**

1. Do not pitch tent near open fire.
2. Do not leave campfire unattended.
3. Do not leave children unattended inside a tent.
4. Do not use heating, lighting or cooking equipment with open flames in or near tents.
5. Do not use other than recommended water repellent compounds on your tent.
6. Do not spray the tent with insecticide.
7. Do not store tent on concrete floor.

#### **DO...**

1. Always extinguish campfire before leaving area.
2. Exercise care when using electricity and lighting in and near tents.
3. Make certain your tent is properly ventilated in all weather conditions. In extreme weather conditions, snow could obstruct airflow and cause asphyxiation unless cleared frequently.
4. Anchor your tent securely to provide additional security from changing climatic conditions. Snow pegs, skis and/or heavy rocks may be necessary to supplement tent stakes and guy cords.
5. Take your tent down and store properly after camping.

## CARE

DO NOT LEAVE YOUR TENT SET UP IN DIRECT SUNLIGHT LONGER THAN NECESSARY. THE SUN'S ULTRAVIOLET (UV) LIGHT DEGRADES ALMOST EVERY FABRIC AND MATERIAL. IF LEFT IN SUNLIGHT FOR PROLONGED PERIODS OF TIME, FABRIC WILL FADE AND WEAKEN. DO NOT STORE TENT ON CONCRETE FLOOR. DO NOT SPRAY THE TENT WITH INSECTICIDE.

Your tent is water repellent, however, it is not waterproof. During heavy rain, some leakage may occur. Keep objects from touching the inside of the tent. Such objects may cause leakage at point of contact. If seam leakage occurs, it can be controlled by applying a seam sealer compound.

**EXERCISE CARE WHEN USING ELECTRIC DEVICES IN AND NEAR TENTS.**

Although our tents and screen houses are constructed to rigid specifications, periods of wind or rain soaking the ground may loosen the stakes and cause the uprights to sink into the ground. This will weaken the rigidity of the overall structure. Water pockets may also form in the roof if the unit is not assembled **taut**, possibly causing broken frames and torn fabric.

## REPLACEMENT PARTS

If you have questions or need to order a part, call 1-800-635-0461 or send an e-mail to [warranty@sierradesigns.com](mailto:warranty@sierradesigns.com). Have your model number or part number ready when you call. DO NOT ORDER BY REFERENCE KEY NUMBER.

Send your request for parts to:  
**Sierra Designs**  
**1 International Ct.**  
**Broomfield, CO 80021**

KEY NO.	MODEL NO 90154820T Crescent 4 Person Dome 8' x 7'		QTY REQ
	DESCRIPTION	PART NO.	
A	Main Pole (Lt. Grey)	90154820T-MP	2
B	Ridge Pole (Black)	90154820T-RP	1
	Complete Frame Set	90154820T-SET	1
	Replacement Fly	90154820T-FLY	1
	Gear Loft	901520T-GLT	1
	3M Guy rope	901520T-GRP	4
	Steel Stake	901520T-STK	11

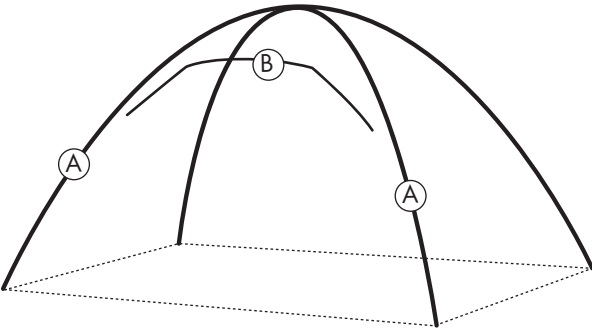

# ASSEMBLY INSTRUCTIONS



MODEL 90154820T **Crescent 4 Person Dome 8' x 7'**

**IMPORTANT:** WE ADVISE YOU TO ASSEMBLE THE TENT ONCE BEFORE GOING CAMPING TO BECOME FAMILIAR WITH THE ASSEMBLY OF THE TENT.

**NOTE:** PLEASE LOOK AT THE REPLACEMENT PARTS DIAGRAM TO SEE HOW YOUR FRAME IS ASSEMBLED. TO PROLONG THE LIFE OF THE TENT FLOOR, SELECT A LEVEL, CLEAN AREA FOR THE CAMPSITE. TO PREVENT DAMAGE TO THE ZIPPER, UNZIP THE DOOR TO ALLOW AIR TO ENTER THE TENT.

TO IMPROVE THE WEATHER RESISTANCE OF YOUR TENT, IT IS ADVISABLE TO USE SEAM SEALER TO COAT ALL EXPOSED SEAMS. YOU SHOULD APPLY ONLY TO THE UNDERSIDE OF THE FLY AND INSIDE SEAMS OF THE TENT. IF APPLIED TO THE OUTSIDE OF SEAMS, DISCOLORATION OF YOUR TENT MAY OCCUR.

**STEP 1:** Spread tent out flat, floor side down.

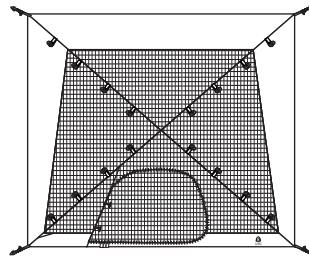

**STEP 2:** Stake the tent to the ground by inserting stakes through the webbing loops at the side corners of the tent. Hammer the stakes into the ground at a 45° angle, making sure the tent floor is pulled out even and tight.

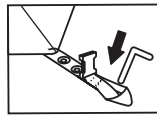

**STEP 3:** Extend fiberglass tent poles by pulling out each section and placing it into the metal ferrule connectors. You will have 2 large diameter (light grey) and 1 small (black) awning poles. The two longest poles (A) are the main tent poles. The other smaller pole (B) will be used with the tent fly.

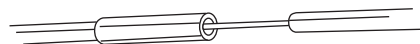

**STEP 4:** Position poles so that they form an "X" across the top of the tent.

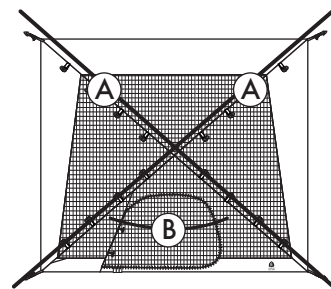

**STEP 5:** Starting at the back of the tent, insert the ends of each pole into (A) the grommet holes in the corner webbing tabs at the base of the tent.

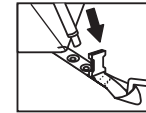

**STEP 6:** Go to the front of the tent and flex the main pole, creating an arch and place the metal end of the pole into the hole at the base of the tent. Repeat for the second main tent pole. Clip plastic hooks to the frame.

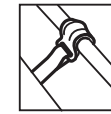

Tent should appear as shown.

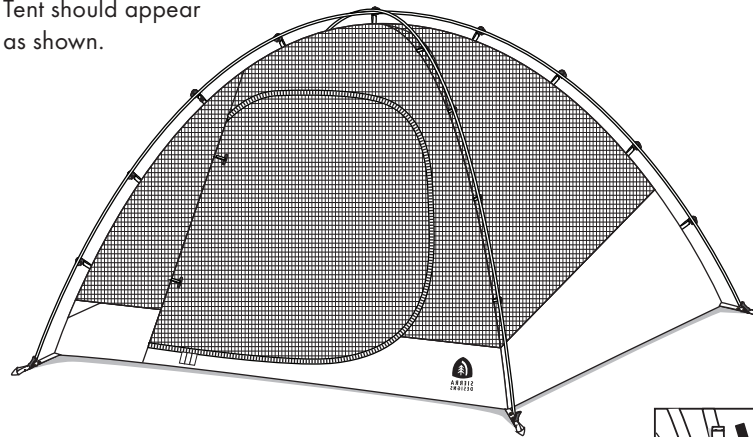

**STEP 7:** Unfold fly and place over tent so the zippered opening is located over the door.

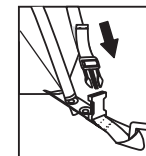

**STEP 8:** Locate the fly pole sleeve on the inside of the tent fly above the door. It is marked with a colored binding. Insert fly pole into sleeve. Attach the fly pole to the tent by flexing the fly pole and inserting each end into the metal grommets above the door. Grommets are located on either side of the front door.

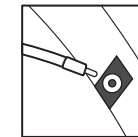

**STEP 9:** Attach the fly to the tent by fastening the Velcro hook and loop fasteners on the underside of the fly to the fiberglass poles at all locations. Finish attaching the fly to the tent by hooking the buckles on the bottom fly corners. Tighten as needed.



**STEP 10:** Guy lines are attached to the tent for additional stability. Extend the guy lines and make a loop at opposite end by using the slider (as shown). Place the loop over a stake and stake to the ground at 45° angle. Adjust slider to make guy rope tight.

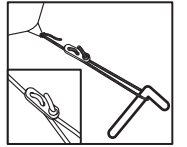

Tent should appear as shown.

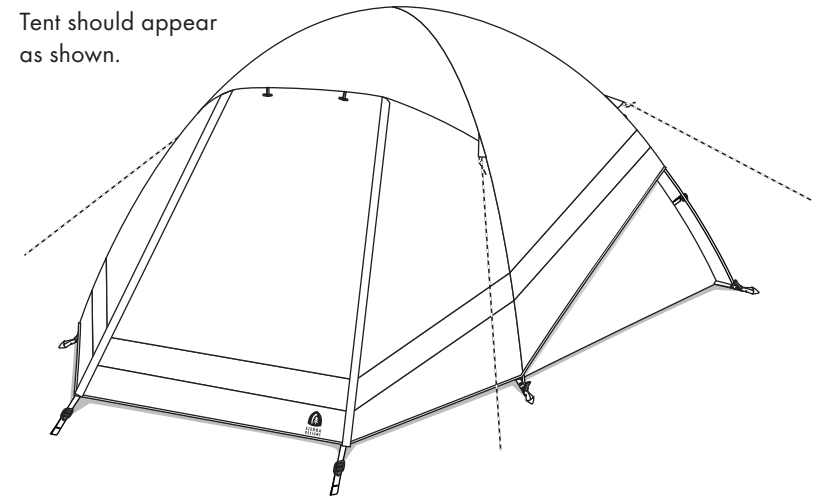

**NOTE:** A mesh gear loft is also included with your tent. Attach to the tent ceiling to hold small camping items within easy reach.

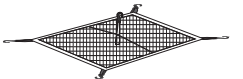

**NOTE:** Front vestibule can be used as an awning with trekking poles and extra rope (trekking poles and rope not included)

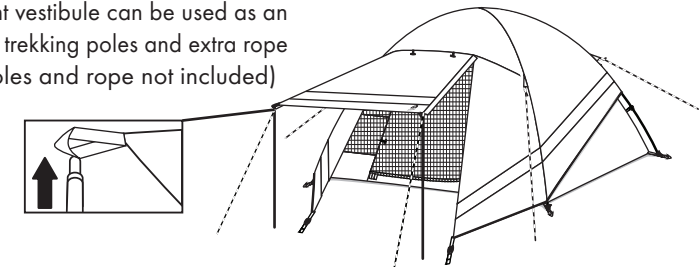

**NOTE:** To take down tent, follow steps above in the reverse order. Be sure to leave door unzipped. Place stakes into stake bag and poles into pole bag, which are provided. The tent should be folded into equal parts toward the center to distribute the bulk. Fold fly and lay on top. Start a small tight roll, the width of your carry bag, with the pole bag placed at the end opposite the doors. Roll tent toward doors to allow air to escape. Once rolled, secure with strings or rope and place into carry bag.

**MAKE SURE TENT IS CLEAN AND DRY BEFORE STORING.**